

USER MANUAL

(TY9)



I. APP Download

Search from the APP store: "V380 Pro" or scan the QR code below to download and install.



II. Point to Point Connection

The device is used at the first time, please initialize the camera.

If you need to save the video, please insert a formatted memory card into the card slot. Supports C10 TF cards of 8GB—128GB capacity.

1.The camera does not have a built-in battery. Before use need to insert the USB plug into the power bank or charger, normal use requires 5V/1A voltage, maximum supports 5V/2A. The red and blue lights will be on, wait for about one minute, and the indicator will turn to red, indicating successfully start up in short-range mode.

If the red indicator and the blue indicator stay on at the same time for 3 minutes, please reset the camera first.

2.Open the mobile phone WiFi list and connect to "MV***" WiFi, such as: MV35804985, please wait for 1 minute after connecting to WiFi.

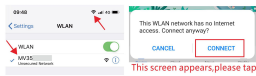

3. After the mobile phone is connected to the camera WiFi, open the APP V380 Pro. Swipe down from the video screen to refresh the screen until it appears as the interface shown.

4. Tap on the screen to set the user name and password. After setting, you can watch video on the mobile phone.

Note:

- If there is no image, please swipe to refresh the screen and try again. Remember the username and password. If you forget the username or password, you can only reset the camera.

- The distance between the mobile phone and the camera should be less than 10m, and there should be no obstacles such as walls, wardrobes and wooden boards between them.

- If the signal from the camera is not found among the Wi-Fi signals in point-to-point connection when the red indicator is on, you can reset the camera and try again.

III. Remote-mode Setting

Note: To ensure signal stability, the distance between the camera and the router should not exceed 10m.

1. Click the Settings button
2. Go to the settings and select "Network"
3. Tap "WiFi station mode"
4. Please select WiFi you want to use. (Note: Wi-Fi name must be composed of numbers and letters, no spaces and special symbols such as &, =, \ and .)

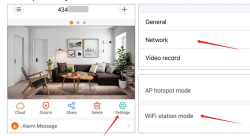

5.Wait for the camera to connect to the Wi-Fi network. If success, the camera indicator turns to blue. If fail, the device will automatically return to the short-range mode and the red light will be on. You need to reconnect the phone to "MV***" WiFi, and re-operate the device to connect to the remote mode. If the connection is successful but the device is offline, exit the APP, re-enter, and refresh a few times

IV. Features Introduction

Real-time monitoring: log in the mobile client to view real-time surveillance video.

Video playback: playback the video stored on the memory card or cloud through the mobile client.

Cloud storage: If you worry about your camera being stolen or the files in the TF card being damaged, you can use paid cloud storage (provided and charged by a third party).

AI human detection: detect human intrusion, greatly reduce the false alarm caused by non-human movement(provided and charged by a third party).

Alarming: the device detects abnormal conditions and sends the alarm picture to the mobile phone client.

V. Interface Introduction

Alarming/Disarming: Can turn off and turn on the Alarm by clicking the button.

Cloud Storage: Cloud storage package purchase and selection (cloud storage can only be used after the device has been set up for remote monitoring).

Device share: After setting remote monitoring on the device, you can send an invitation to a friend to share the camera, and the other party can use the camera together. **Note:** Invitees need to register V380 account first.

Delete: Delete the device, no more monitor any more

Setting: such as changing the password,recording, language,IF, etc.

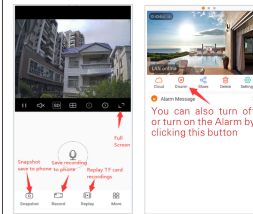

VI. Video Record

Automatic recording: 24/7hours recording, and the recording duration is 10 minutes per videos. The loop recording can be started only after the memory card is inserted. When the memory is full, the latest recording file will automatically overwrite the oldest.

Alarm recording: after the alarm is activated, a 20-seconds to 2-minutes video will be automatically shot and saved on the memory card or cloud server, (only by purchasing cloud storage plan video can be saved on cloud server).

Recording and audio: after this function is enabled, TF card recording can realize audio synchronization.

Video resolution: "HD" and "SD"

VII.Reset

Insert a toothpick or a needle into the reset hole about 5 seconds, and the red and blue light will light up, then turn to red only, that means the camera has been reset successfully.

When using the camera, it should maintain a certain space with other objects, let the camera be in use in ventilation areas.

When the camera is in use or in charge, it is forbidden to use any object to cover the outer casing and the surrounding heat release holes. Blocking the vents can cause the device to overheat. If the camera is damaged caused by this reason or other serious consequences, the seller is not responsible and not bear any legal consequences.

VIII.Precautions for use

Support Wifi: the camera supports 2.4G Wi-Fi connection but does not support 5G or SIM Wi-Fi band connection.

TF storage: 8GB memory allows two days of recording, and 128GB memory allows up to a month of recording.

How to play the video: The video stored on the TF card can be viewed on the computer through the card reader, or directly through the mobile phone, and the video stored on the cloud storage can be directly downloaded and viewed through the mobile phone.

V380Pro account and cloud storage: One V380pro account can be connected to unlimited number of cameras, but one camera only supports one cloud storage. V380Pro account can be logged in on any other mobile phones.

Usage: please strictly abide by the relevant laws and regulations of the country, do not use this product for any illegal use, otherwise you will be responsible for the consequences.

Operating temperature: 0-45 °C. In order to extend the service life, it is best to use at room temperature. It is forbidden to use anything to cover the shell and its heat dissipation hole.

Working humidity: 20%-80%. Please do not put the product in a humid working environment. The product does not have waterproof function.

Work environment: this product belongs to precision electronic products, do not make it subject to strong shock and vibration; Do not use in the vicinity of strong magnetic field, strong electric field, inflammable and explosive articles.